



Atex barrier with galvanic isolation

- For installations in areas at risk of explosive atmospheres
- 1 digital input
- DIN rail mounting
- Galvanically isolated

KET-BAX-100

Applications

Accounting

The **KET-BAX-100** is an **Atex Barrier** designed to transmit On-Off signals from a proximity contact or switch located in a hazardous area to the safe area. It is equipped with a **digital input** with voltage-free switch or 2-wire proximity sensor and **two relay outputs** (5 A - 250 VAC). Maximum flexibility of power supply, direct from the mains or low voltage, both DC and AC. Together with the KET-CGP / CGT gas meters, it is essential in the monitoring of a **gas system** for safety purposes.

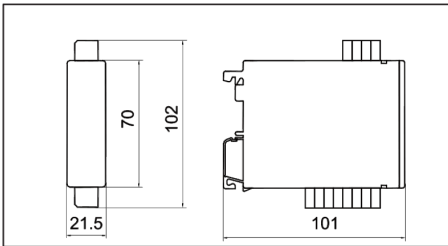

Technical Features

General specifications	Protection Range: IP20 Operative Temperature: -20 ÷ +60 °C Storage Temperature: -25 ÷ +70 °C Relative Humidity: MAX 95% not condensing
Case	Dimensions: 21.5 x 70 x 101 mm (W x H x D) Mounting: DIN-rail Required DIN modules: 1 DIN module Electric Board Type: Industrial or switchboard Material: ABS
Power supply	Supply Voltage: 110 ÷ 230 VAC ±10% (48 ÷ 62 Hz); 12 VDC ±10%; 24 ÷ 48 VDC ±10% Consumption: = 4.5 VA or 1.6 W Connectors types: Screw terminal
Digital inputs	Channels: 1 Digital Inputs: Voltage free switch or 2 wires proximity sensor
Relay outputs	Channels: 2 switch outputs Voltage Output: 250 V @ 5 A; max 100 VA Maximum Rated Current: 100 mA Isolation: Galvanic isolation 2500 VAC 50 Hz
Certifications	Referends Standard: EN/IEC 61326, EN/IEC 61000-6-2, EN/IEC 61010-1 Approvals: ATEX certificate: LCIE 02 ATEX 6104X - INERIS 14 ATEX 3015X; ATEX classification: CE 0081 Ex II (1) G/D; IECEx certificate: IECEx LCI 09.0013X; SIL classification: SIL 2 according to IEC 61508 Security: EN/IEC 60079-0, EN/IEC 60079-11 [Ex ia] I or [Ex ia] IIC or [Ex ia] IIB [Ex iaD] I or [Ex iaD] IIC or [Ex iaD] IIB, [Ex nA] EN 60079-0, EN 60079-15